

## MIAMI OPERATIONS

### HAZARD RECOGNITION

*At Miami, we are "ALL IN" for safety by preventing fatalities.*



**The following rules and guidelines apply during your visit at Miami operations. For your personal safety and the safety of others, observe these rules and guidelines at all times.**

#### CONFIDENTIALITY AGREEMENT

While on Miami operations property, use of photographic or video equipment or similar technology is prohibited without the express prior written consent of Freeport-McMoRan. In consideration for the granting of permission to enter the Miami operations property, I hereby agree all knowledge and information acquired or otherwise obtained by me relating to the site's operations may not be used by me for any purpose or divulged to any person other than authorized representatives of Miami operations without the express prior written consent of Freeport-McMoRan.

#### RELEASE AND INDEMNITY

On behalf of myself, my parent and subsidiary corporations, in consideration for the granting of permission to enter upon the property owned by Freeport-McMoRan Miami operations, I release and agrees to hold harmless and indemnify Freeport-McMoRan, its affiliates, officers, employees, and agents, from and against all claims and all injuries, losses, and damages to any person or property arising out of entry onto the company's operations from the date of this release.

#### HAZARD RECOGNITION AND AVOIDANCE

- Freeport-McMoRan prohibits the transport or use of alcoholic beverages, drugs and narcotics on company property.
- Stay clear of working mobile equipment as the operator may not see you.
- Observe all No Smoking areas.
- Seatbelts must be worn by the operator and passengers while vehicles are in motion.
- Authorization is required to drive on roads in the Mining Division areas.
- A two-way radio with the mine frequency is required to drive in the Mine Division areas.
- Left-hand traffic is used throughout the Mine Division area.
- Maximum speed is 35 mph on mine roads.
- Observe traffic regulatory signs and rules at all times.
- If authorized to be in the Smelter, Rod Plant, Refinery or Maintenance Shop areas, watch for overhead cranes in operation. Cranes in motion will have audible and visual alarms.

- Do not walk under suspended loads.
- Be alert for slip, trip and fall hazards.
- Use proper eye protection in areas where cutting and welding work is being performed.
- One-ton vehicles or larger must be chocked and have the park brake set when parked.
- All vehicles are subject to periodic, unannounced inspections at any location on the site.
- Company policy is to arrest and prosecute anyone apprehended for committing theft from the plant premises.
- The maximum speed on our property is 35 mph unless otherwise posted. This is strictly enforced and violators will be cited. Repeat violators will lose their driving privileges on this property.

#### BASIC PERSONAL PROTECTIVE EQUIPMENT – PPE

- Hard hat
- Safety glasses with side shields
- Hearing protection
- Safety toe boots
- Long pants that extend over the top of boots
- Additional PPE requirements may include:
  - Reflective vest
  - Long sleeved shirt (in required areas)
  - Foam-fitted safety glasses, goggles or face shield
  - Fitted respirator with Acid/Gas P100 Cartridges – on your person at all times
  - MVP 100 Mercury cartridges for working in the solar pad area
  - Approved chemical-resistant suits for working in strong acid areas or caustic handling and storage areas
  - Safety toe boots with metatarsal guards and a defined heel
    - Visitors may wear closed-toed shoes with prior approval.
    - Truck drivers must have safety toe boots. Metatarsal guards are not required.

#### WIND SOCKS

There are multiple windsocks throughout the site that show you which direction the wind is blowing. In the event of a possible gas release, evacuate in the opposite direction (upwind) immediately.

#### GAI-TRONICS

The Gai-Tronics communication system is located throughout the smelter and designated by **RED** lights. When lit, these lights indicate a mandatory evacuation of the smelter areas. The system can be used to communicate with operators in the acid plant control room as well as to communicate other emergencies if necessary.

#### SAFETY SHOWERS

Safety showers and eye wash stations are located throughout the Miami operations and designated by **BLUE** lights. In the event you are exposed to a hazardous chemical or substance, proceed to the nearest safety shower and flush with water immediately for a minimum of 15 minutes, then seek medical attention.

#### PHONE NUMBERS

- On Site Emergency: (928) 473-7555
- Emergency: 911
- Main Gate for Non-Emergency: (928) 473-7100
- Smelter Control Room: (928) 473-7036
- Acid Plant Control Room: (928) 473-7037

## FATAL RISKS PRESENT AT MIAMI OPERATIONS

These symbols indicate a Fatal Risk may be present in the area. Please consult with local leadership before proceeding to ensure all Critical Controls are in place to prevent any serious incidents from occurring.



Blasting



Confined Spaces



Contact with Molten Material



Drowning



Entanglement and Crushing



Exposure to Electrical Hazards



Fall from Heights



Falling Objects



Fire



Ground Failure



Hazardous Substance – Acute Exposure



Hazardous Substance – Chronic Exposure



Interaction with Aircraft



Lifting Operations



Uncontrolled Release of Energy



Vehicle Impact on Person



Vehicle Collision or Rollover



Rail Collision



Rail Impact on Person

# FREEPORT MIAMI: Site Delivery Locations

Remember:  
 Left hand traffic in mine  
 Cell Phone use prohibited while operating vehicles  
 Follow gold star to return to security gate



- ACCESS ROAD
- HAUL ROAD (Restricted Access)

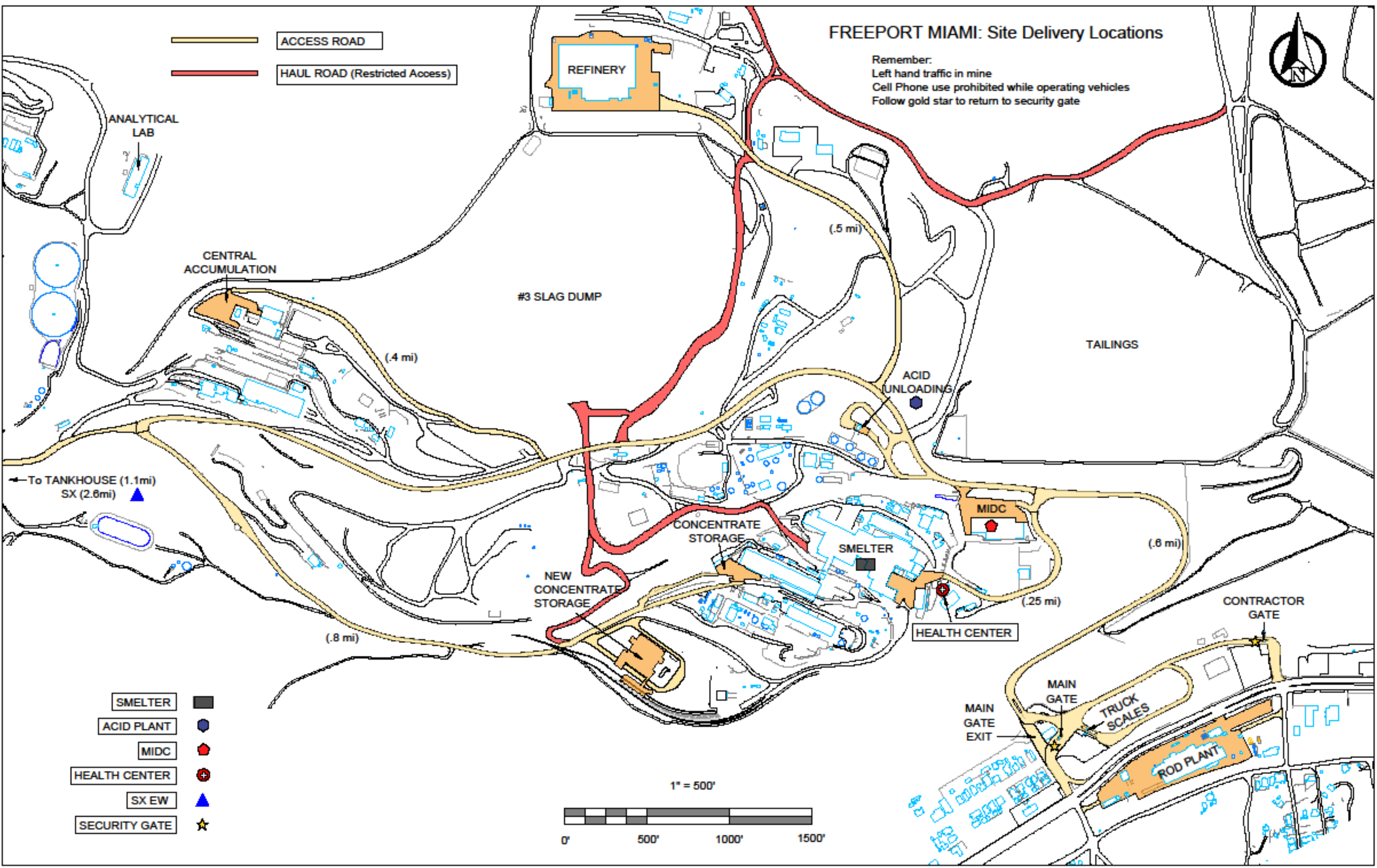

- SMELTER
- ACID PLANT
- MIDC
- HEALTH CENTER
- SX EW
- SECURITY GATE

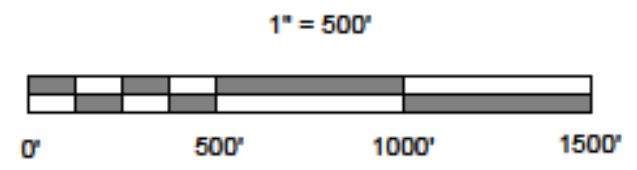

← To TANKHOUSE (1.1mi)  
 SX (2.6mi) ▲

CONTRACTOR GATE

MAIN GATE

MAIN GATE EXIT

TRUCK SCALES

ROD PLANT

HEALTH CENTER

SMELTER

CONCENTRATE STORAGE

NEW CONCENTRATE STORAGE

ACID UNLOADING

TAILINGS

#3 SLAG DUMP

CENTRAL ACCUMULATION

REFINERY

ANALYTICAL LAB